

Orchard Park Strategic Plan



*Prepared by the Parks and Recreation Committee
of New Britain Borough
2016*

Contents

Mission Statement	1
History of Orchard Park	2
Management and Stewardship Plans	3
Park Rules and Regulations	9
Appendix 1 Orchard Park Map	
Appendix 2 Site Location Map	
Appendix 3 New Britain Borough Ordinance Establishing Parks and Recreation Committee	
Appendix 4 Community Garden Rules	

Mission Statement

The Parks and Recreation Committee of New Britain Borough, in collaboration with the New Britain Borough government, is committed to providing an area of natural enjoyment, to supporting the preservation of wildlife habitat and native plant species, and to fostering community participation in passive recreation. We are dedicated to supporting these ideals in the present and future planning and management of Orchard Park.



Entrance to Orchard Park from Covered Bridge Park

History of Orchard Park

In 2013, New Britain Borough used Bucks County Open Space funds to purchase 5.5 acres in Doylestown Township adjacent to Covered Bridge Park. This parcel, now known as Orchard Park, was originally part of a large working farm and orchard. The drier areas in the front of the farm along Keeley Avenue were planted with fruit trees. The rear areas were either planted with evergreens or allowed to revert to woodlands or a wetlands meadow. The area nearest the still standing farm house contained a large barn, which has been removed, and an open sunny plot of grass. The farm's past land use is still apparent in Orchard Park and influences the current vision for the future use and management of this park.



Orchard Park adjoins Covered Bridge Park, a 14.7 acre park located on Keeley Avenue in New Britain Borough, which has been owned and operated by the New Britain Civic Association since 1957. Nestled along the Pine Run Creek and bounded by New Britain Borough, New Britain Township and Doylestown Township, Covered Bridge Park is a regional park open to the public. The name Covered Bridge Park refers to the Pine Valley Covered Bridge located at the entrance to the park. The park is principally for active recreation, with playground equipment, a picnic pavilion, soccer field, basketball court and a pond. In 2015 the Destination Peace Valley Bike and Hike Trail, a trail connecting Doylestown with Peace Valley Park and Lake Galena, opened through the park.

While Orchard Park is intended for lower impact recreation than Covered Bridge Park, the Borough and the New Britain Civic Association have agreed that Orchard and Covered Bridge Parks should be treated in some ways as one unit to avoid the duplication of some facilities, such as parking, water, and restrooms. Together with the 115 acre Pine Run Reservoir, which adjoins both parks, these two parks are now part of one of the largest protected open spaces in the region. These three distinct areas each provide a different experience, and each is expected to see increased usage in the years to come.

Management and Stewardship Plans

Description: The Orchard Park tract is a 5.5 acre L shaped plot that extends from Keeley Ave. and is adjacent to Covered Bridge Park and the Pine Run Reservoir. It is bordered on two sides by residential properties. For management purposes, the Orchard Park Committee has divided the park into the following six units:

The Orchard



- **Description:** The existing one acre fruit orchard is located on a 75 foot wide strip of land that extends 600 feet from Keeley Ave to the field in the main park. Most of the trees are old apple trees.
- **Management Plan:** We intend to preserve this area as an orchard, with new trees planted as needed to replace the current trees which are very old and in decline. Given the amount of work and chemicals required by a commercial fruit orchard, however, fruit production will not be a main concern. Periodic pruning and maintenance will be needed, however. To improve wildlife habitat, we should consider maintaining the area around the trees as a meadow by only mowing it once a year. A mowed path through this section will provide pedestrian and emergency vehicle access to the park from the eventual bike and hike trail along Keeley Ave. As old orchards are prime habitat for bluebirds, a number of bluebird nesting boxes have been erected in this area.

The Lawn



- **Description:** A large grassy area extends from the small brook to the northeast boundary behind the old orchard. This area also contains the New Britain Borough community garden, which is protected by deer fencing. Uphill from the garden is an area of grass suitable for family recreation. With the addition of a bench and several picnic tables, this area provides a large, quiet area for recreational activities.
- **Management Plan:** This area will be maintained as an open play area which will require turf management, lawn mowing, and regrading for safety and water management. This area will also be buffered from neighboring residential properties by the planting of native tree and shrub borders.

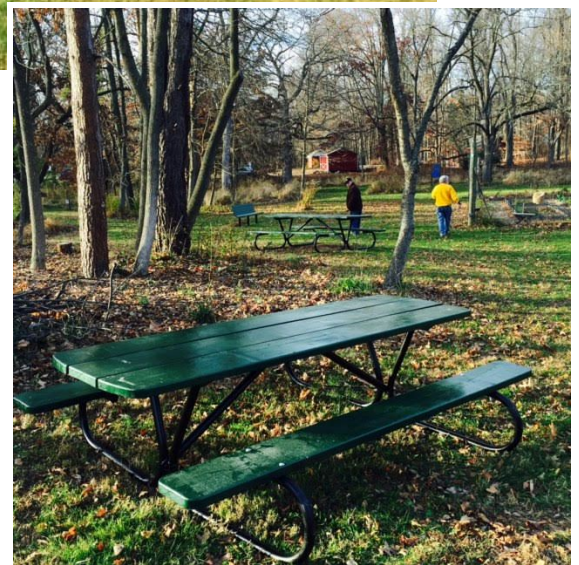

The Community Garden



- **Description:** The Community Garden is a 70' x 70' fenced-in area of raised beds for the use of community gardeners.
- **Management Plan:** This garden is managed by a sub-committee of the Orchard Park Committee. There is a small annual membership fee for participation and the garden is maintained by its members. See Appendix 3 for the Community Garden rules.

The Woods



- **Description:** Approximately 1.1 acres of the park is wooded. Located in the woods is a small glen which is currently accessible by a mowed path. The area is surrounded by trees and would be an ideal location for an outdoor classroom for summer campers, scout troops, or birders interested in learning more about the environment, native plants and wildlife.
- **Management Plan:** This area was cleared of dead or dying trees and some invasive species. Going forward, periodic inspections of the trees and understory plants are recommended to insure that dangerous branches or trees are identified for removal.

Invasive plants such as wild grape, Japanese honeysuckle, multiflora rose, etc. will require yearly clearing to prevent their re-growth. Some planting of native plants, shrubs and trees is recommended to increase more diversity of plant species in this area.

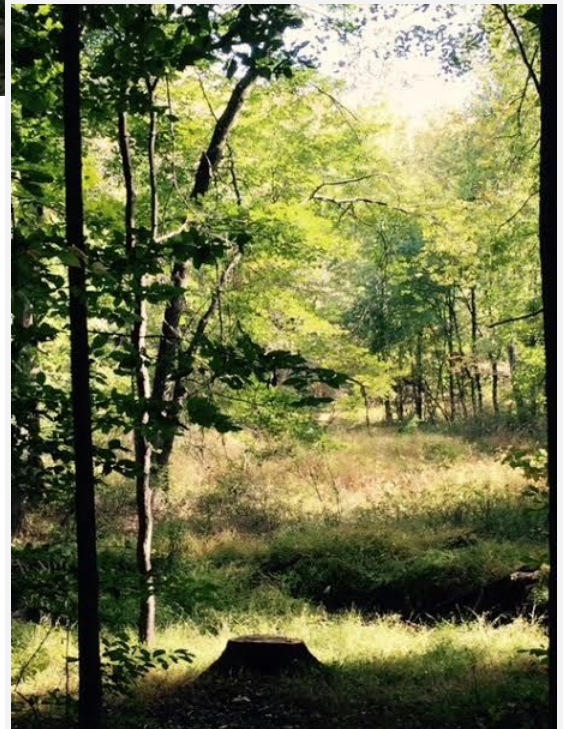

The Wetlands

- **Description:** This area is officially designated as a wetland and is located in the far back of the park abutting the soccer field in Covered Bridge Park and the houses on Wagon Wheel Road. It is heavily shaded and is a very wet area. This area may be subject to storm flooding from street drains, suburban yards, and occasional flooding from a small brook running through the area. There are some parts of this area where erosion and water runoff from neighboring properties is a problem.
- **Management Plan:** The area has little diversity, and would benefit from planting a variety of native plants. Rain gardens could potentially help curb the water runoff and reduce the erosion. No mowing is permitted in this area.

The Right of Way

- **Description:** An approximately 25 foot wide sewer right of way extends from Keeley Ave. to the rear of the park along the boundary behind the private residences fronting on Lamp Post and Wagon Wheel Roads.
- **Management Plan:** No changes to the right of way are proposed other than maintaining it as a mowed buffer between the park and neighboring properties.

Park Boundaries:



Management Plan: To delineate the park's boundary lines, small boundary signs have been installed at regular intervals along the park's perimeter. In some areas, sections of fencing or native plantings will be used to buffer the park from residential areas.

Wildlife Habitat:



Screech Owl Box



Bluebird Box



Winter Roosting Box

Management Plan: One of the management goals for Orchard Park is to create suitable habitat for birds and other wildlife. This will be done by installing nesting and roosting boxes for birds, installing a bat house, planting native, wildlife friendly, trees and shrubs, and not using pesticides on the property.



Since New Britain Borough is a PA Audubon Bird Town, Orchard Park has been registered in the Bird Town program's Habitat Recognition Network.

Orchard Park Rules and Regulations

The following rules and regulations for Orchard Park have been established by the Parks and Recreation Committee of New Britain Borough and will be posted inside the kiosk at the Orchard Park entrance:

- The park is open from dawn to dusk
- Dogs must be leashed at all times
- Pick up after your dog
- No littering
- No alcoholic beverages
- No open fires
- No camping
- No hunting or trapping
- Authorized vehicles only
- Respect all boundary lines
- Vandalism will be prosecuted



NOTE: In addition to these posted rules, all the rules specified in the New Britain Borough Code (Chapter 295. Parks and Recreation) apply. These rules can be found at <http://www.ecode360.com/15540387>. Also, since Orchard Park is located in Doylestown Township, all Doylestown Township park rules and regulations apply, which can be found at <http://www.doylestownpa.org/police/ordinances/>







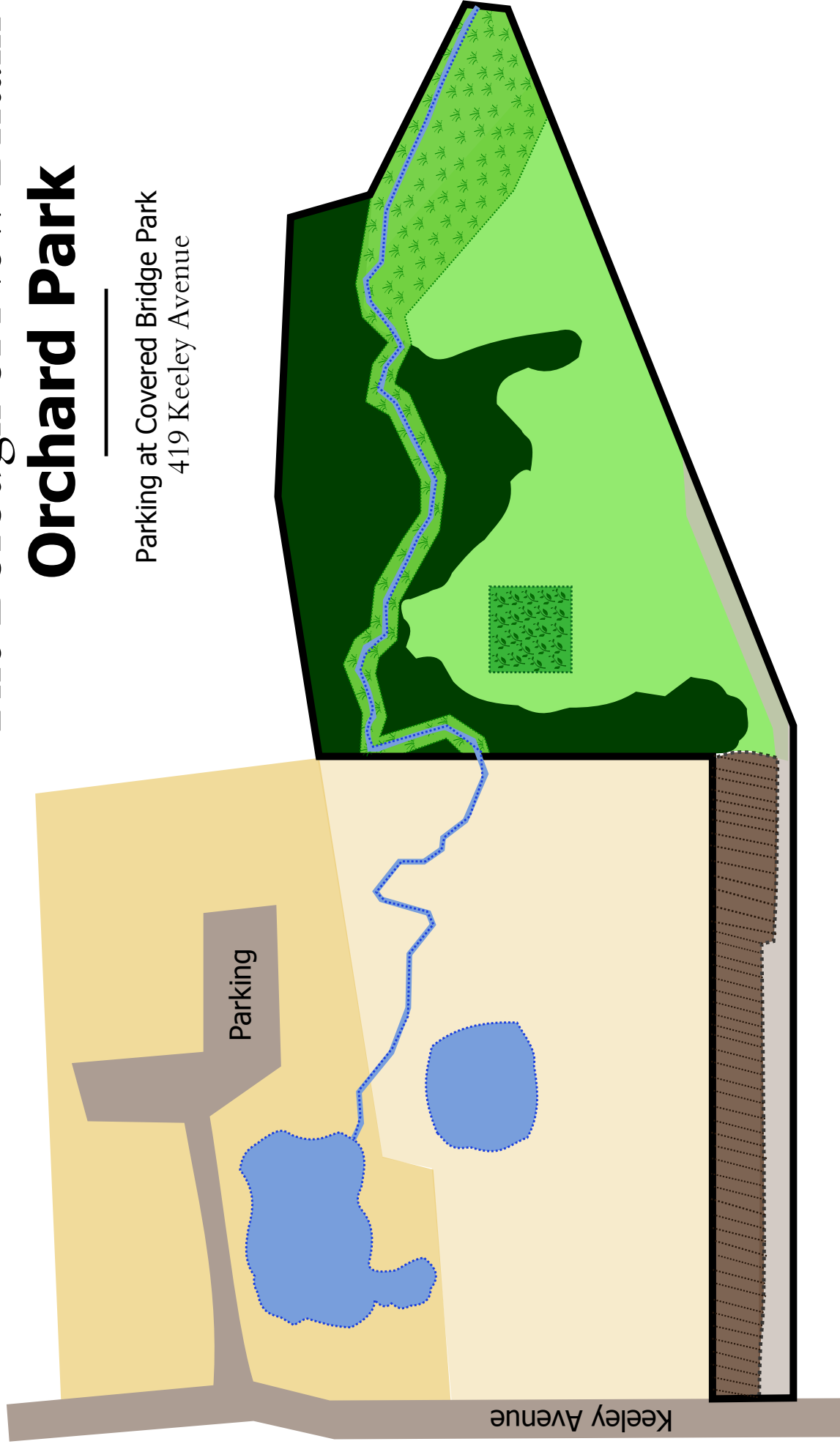

The Borough of New Britain

Orchard Park

Parking at Covered Bridge Park
419 Keeley Avenue



Map Legend

- | | | | | | |
|---|---------------------|---|--------------------------|---|----------------------|
|  | Covered Bridge Park |  | Stream |  | The Community Garden |
|  | Private Property |  | Woods |  | The Lawn |
|  | Right of Way |  | Wetlands / Riparian Area |  | The Orchard |

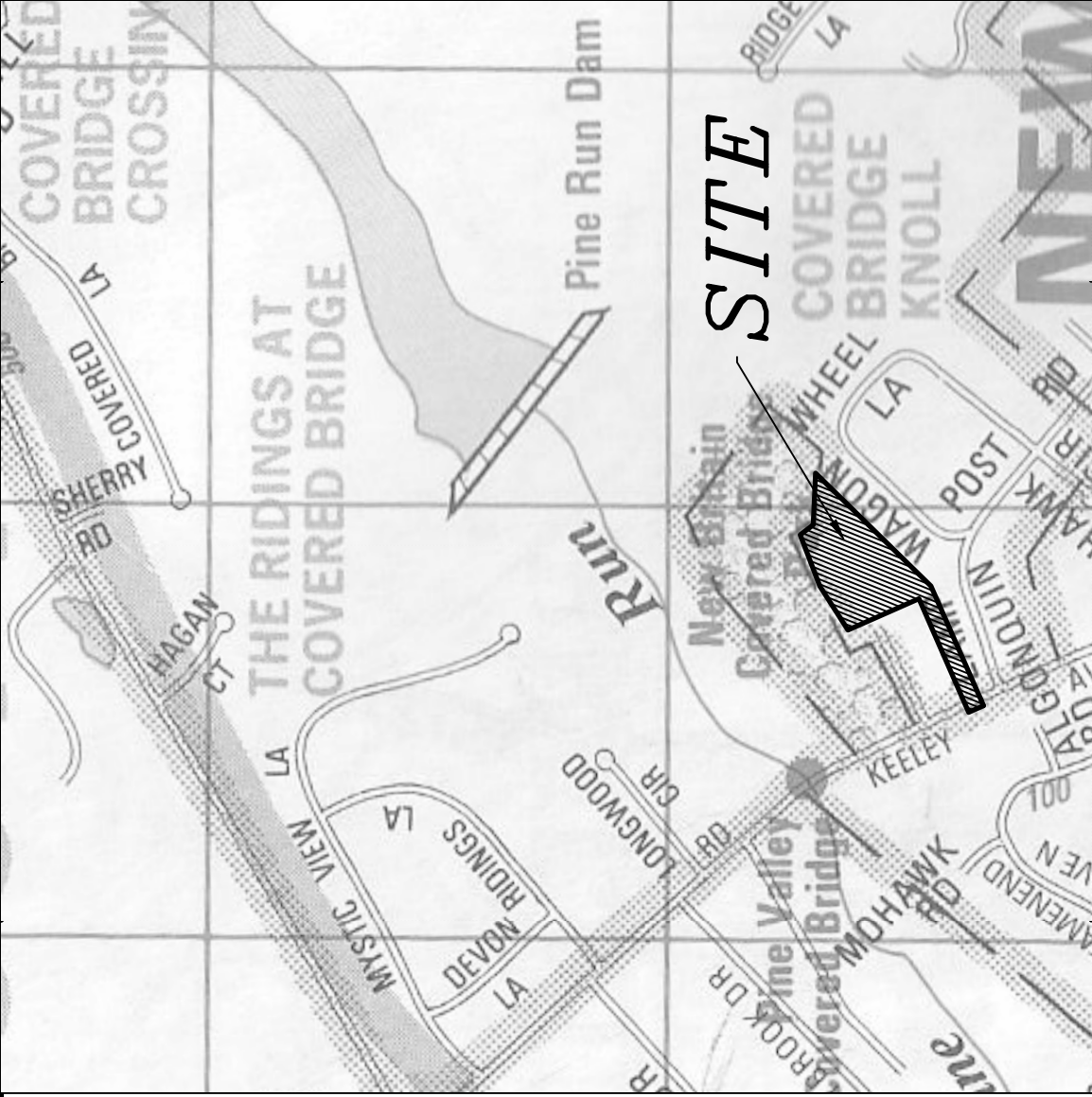

SITE LOCATION MAP
SCALE: 1" = 800'

SITE DATA

T.M.P.'s #9-2-1-2
ZONE - R1a - (RESIDENTIAL DISTRICT)
USE - C5 (RECREATIONAL FACILITY (PUBLIC))
SITE AREA (GROSS) = 4.07 AC.
OWNER OF RECORD:
NEW BRITAIN BOROUGH
45 KEELEY AVENUE
NEW BRITAIN, PA 18901
215-348-4586
SITE ADDRESS:
ORCHARD PARK
219 KEELEY AVENUE
NEW BRITAIN, PA 18901
215-348-4586

SHEET INDEX:

SHT 1 OF 2 PARK IMPROVEMENT AND EROSION CONTROL PLAN
SHT 2 OF 2 DETAIL AND NOTE PLAN

Notes:

- THIS PLAN HAS BEEN PREPARED FROM A PLAN ENTITLED 'VENTRISCA' - MINOR SUBDIVISION PLAN, DATED 10/15/15, BY MARK G. HINTENLANG, P.E., 34 FRANCIS MEYERS ROAD, NEW BRITAIN, PA 18901, 215-348-4586.
- THE INTENT OF THIS PLAN IS TO SLIGHTLY RE-GRADE AN AREA OF THE PARK TO ELIMINATE TRIPPING HAZARDS AND TO DIVERT FLOWS FROM THE COMMUNITY GARDEN.
- PARK STRUCTURES AND FENCING ARE SHOWN IN APPROXIMATE LOCATIONS.
- SEE SHT 2 OF 2 FOR EROSION CONTROL NOTES AND DETAILS.

PLANT LIST

KEY	BOTANICAL NAME	COMMON NAME	QUANTITY	SIZE	COMMENTS
AR	ACER SACCHARUM	SUGAR MAPLE	2	2-1/2"	B&B
PS	PINUS STROBUS	WHITE PINE	3	8" HT	B&B
TS	THUJA STANDISHI X PLIATA	GREEN GIANT ARBORVITAE	5	8" HT	B&B
BN	BETULA NIGRA	RIVER BIRCH	3	2-1/2"	B&B
NS	PICEA ABIES	NORWAY SPRUCE	3	2-1/2"	B&B
TOTAL			16		

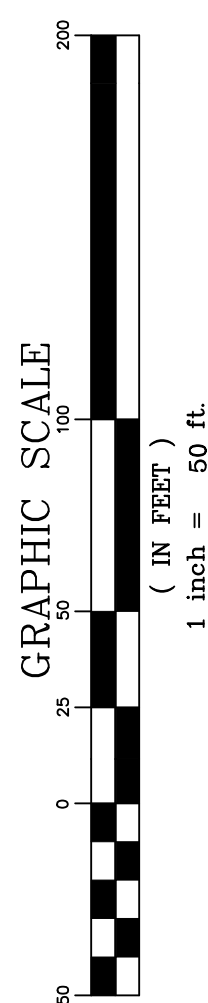

SOILS CLASSIFICATIONS:

Abbreviation	Soil Name	Capability
Bo	Dowdsville silt loam, 3-8% clay	3w
LgB	Dowdsville silt loam, 3-8% clay	2a
ReB	Reading silt loam, 3-8% clay	2a
UgB	Reading silt loam, 3-8% clay	3w

SOIL LIMITATIONS:
Soil limitations are rock (>40") and water table (6"). Minimal excavation is proposed.
Should water be encountered, the excavation should be pumped with suitable E&S devices to eliminate the possibility of erosion and flow of sediment laden runoff from the site as approved by the BCCD.

LEGEND

EXISTING TRACT BOUNDARY	---
EXISTING 1' CONTOUR	---
EXISTING 5' CONTOUR	---
PROPOSED CONTOUR	---
EXISTING EDGE OF ROADWAY / CURBLINE	---
SOILS BOUNDARY	---
PROPOSED DRAINAGE AREA BOUNDARY	---
FILTER SOCK CONSTRUCTION ENTRANCE	---
STABILIZATION FABRIC	---

Preliminary / Final Plan

Project : NEW BRITAIN ORCHARD PARK
TMP# 9-2-1-2 - 219 KEELEY AVE.
DOYLESTOWN TOWNSHIP
BUCKS COUNTY, PA

Owner:
NEW BRITAIN BOROUGH
45 KEELEY AVENUE
NEW BRITAIN TOWNSHIP, BUCKS COUNTY, PA
215-348-4586

Revisions
Date

10/19/15 REV. PER BCCD 10/15/15 LTR.

CALL BEFORE YOU DIG!
PENNSYLVANIA LAW REQUIRES
3 WORKING DAYS NOTICE FOR
CONSTRUCTION PHASE AND 10 WORKING
DAYS IN DESIGN STAGE - STOP CALL
Pennsylvania One Call System, Inc.
1-800-242-1776

Information shown on this plan represents professional
services expressing ideas and designs developed and owned by
Mark G. Hintenlang, P.E., 34 Francis Meyers Road, New Britain, PA 18901, 215-348-4586. Reproduction of this
plan without written approval of Mark G. Hintenlang, P.E., is not
permitted. Unauthorized reproduction of a copy of this plan
for any purpose will be considered a violation of the
copyright laws and a theft of corporate assets.
Unauthorized alterations of the plan will be considered a
violation of the professional code of ethics. Any violation
will be prosecuted to the fullest extent of current statutes.

Written dimensions shall have priority over scaled
dimensions. All dimensions, elevations, locations, and
constructions, shall be verified by the Contractor prior to
construction, and the Owner shall be notified of any
discrepancies, with the information shown on the drawings.
All ideas, designs and arrangements presented herein
are developed for use on, and in connection with, the
project being prepared for the Owner. These
plans may not be reproduced or altered without the
expressed written permission of the Owner.

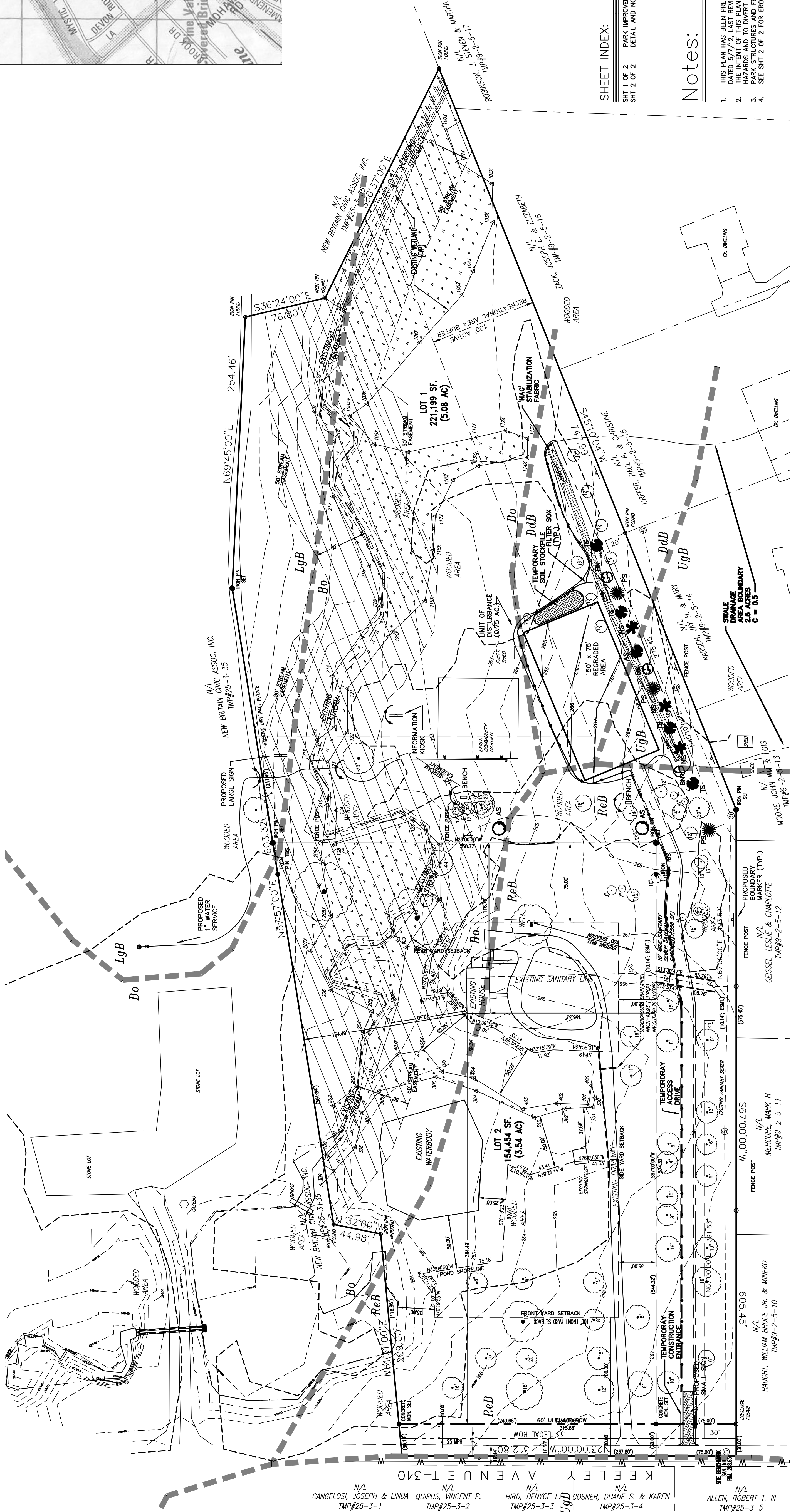

Appendix 4

New Britain Borough Community Garden Rules and Regulations

1. The basic fee for an individual garden plot in 2016 is \$25.00 for New Britain Borough residents and \$30.00 for non-residents. Garden fees for each year are determined during the Spring annual meeting. Each plot remains under the stewardship of its registered plot holder on an evergreen basis unless forfeited through unpaid dues or in violation of these rules and regulations.
2. If Community Garden is fully occupied, a waiting list will be maintained to fill plots as they are vacated. Plots will be assigned firstly to New Britain borough residents and then by seniority on list via first-come basis. Members may only hold one plot if there is an active waiting list.
3. Any plot not cleared of weeds and planted with at least three (3) rows by June 1st will be forfeited and given to next person on waiting list (as necessary.) Any plot holder who has overgrown weeds will be notified via email that their plot requires clearing. If weeds are not removed or special circumstances communicated (health, travel) following the second notice, the plot will be re-assigned and all fees and planted materials forfeited.
4. Plot holders must keep all paths adjoining their plot free of trash and manage weeds. Compost garden clippings and organic material are to be placed on compost pile. Trash should be removed from the garden property to proper disposal. Diseased plant material or woody items should be disposed of in the dumpsters at Covered Bridge Park.
5. Plot holders promise to devote a minimum of twelve (12) hours per year towards the general maintenance and improvement of the garden as a whole. This includes planned work days and weeding/upkeep of shared areas. Failure to meet the participation requirement may result in forfeiture of plot.

6. For the benefit of everyone, crops should be harvested as soon as possible when mature to help control pest management. No non-plant items should be left in the garden overnight. Extra crops should be shared with the local Baptist Church food larder or borough neighbors.
7. This community garden is chemical-free and organic. Pest and weed control should be preventative and biologically-based. All shared tools should be rinsed free of dirt prior to storage and must be used with proper care. Donation of quality tools for general use is encouraged.
8. The Community Garden is contained within Orchard Park and is overseen by New Britain Borough's Parks & Recreation Committee. A liaison will be elected to oversee the general welfare, enforce rules and regulations, and manage communications with the Borough and Parks committee. All recommendations for improvements should be presented to the committee. The committee will have the authority to act on any recommendation that is in the best interests of the community and approved by majority vote. The liaison may maintain a bank account for plot fees and miscellaneous receipts. A copy of each bank statement shall be provided to the board. The account shall not exceed \$500 at any one time so that any excess shall be paid to the Borough.
9. Each member understands that they are allowed the privilege to use a portion of the Open Space area owned by New Britain Borough. All activities, access, and egress of vehicles and individuals, should be respectful of maintaining ideal property conditions for all neighboring properties and the Borough.
10. Email will be the primary means of communication.
11. In the event of travel, illness, or issues impacting the regular maintenance of your plot, contact the Steering Committee to arrange for care, harvesting, and watering.
12. Participation in the New Britain Community Garden is conditional upon observance of these rules. New Britain Borough Council may modify, move, or discontinue the Community Garden. No compensation will be given as a result of any Council action.